

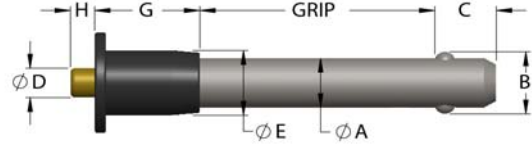

Sky-Loc™ Button Handle

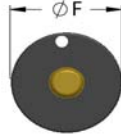

Typical Dimensions*

Nom. Dia. ^F	A (Dia.)		Ω B (+/- .005)	C (+.000/- .030)	D	E	F	G	H	Calculated double-shear strength (lbs)			Min tensile load (2 balls) ^A			
	Max	Min								17-4 SS	4130	304 SS	17-4 SS	4130	304 SS	
3/16	0.1885	0.1870	0.220	0.260	0.240	0.400	0.750	0.760	0.125	5,150	4,600	1,500	200	200	150	
1/4	0.2485	0.2470	0.289	0.290	0.194	0.400	0.750	0.760	0.125	9,200	8,200	2,200	230	230	180	
5/16	0.3110	0.3095	0.375	0.330	0.250	0.430	0.750	0.800	0.125	14,400	12,800	3,500	510	510	400	
3/8	0.3735	0.3720	0.440	0.365	0.281	0.530	0.875	0.875	0.160	20,600	18,400	4,500	575	575	450	
1/2	0.4985	0.4970	0.594	0.460	0.316	0.650	1.000	0.940	0.240	36,800	32,800	11,500	1,160	1,160	900	
5/8	0.6235	0.6220	0.750	0.580	0.316	0.860	1.250	1.245	0.240	57,500	51,200	20,000	2,070	2,070	1,500	
3/4	0.7485	0.7470	0.887	0.670	0.302	1.000	1.850	1.410	0.310	82,500	73,600	23,000	2,950	2,950	2,200	
1	0.9985	0.9970	1.219	0.890	0.740	1.300	2.200	1.880	0.310	147,000	131,000	35,000	5,480	5,480	4,100	
Notes:										*Virtually any dimension can be tailored for your application.						
Dimensions in Inches																
Grip length +0.020, -0.000. Custom tolerances available.																
^F Pins can be any diameter 3/16" and up, including metric																
^B Dimension is measured over the balls																
^A Add 30% for 4-ball pins																



Big Sky Precision, Inc.
 PO Box 470 (mailing)
 301 N. Railroad Avenue (shipping)
 Manhattan, Montana 59741
 (406) 284-3955
 Fax: 284-3956
 Paul's Cell: 539-1599
 Toll Free: (888) 213-1492

www.bigskyprecision.com